

محمد حبیبی پارسا*^۱، محمد کاظمی^۲ و محمد حسن پیش بین^۳

^۱دانشیار دانشکده مهندسی متالورژی و مواد - پردیس دانشکده های فنی - دانشگاه تهران
^۲دانش آموخته کارشناسی ارشد مهندسی متالورژی و مواد - پردیس دانشکده های فنی - دانشگاه تهران
^۳استادیار دانشکده مهندسی متالورژی و مواد - پردیس دانشکده های فنی - دانشگاه تهران
(تاریخ دریافت ۸۵/۶/۲۵، تاریخ روایت اصلاح شده ۸۶/۲/۳، تاریخ تصویب ۸۶/۵/۲۷)

چکیده

(Yoshida)

واژه های کلیدی:

مقدمه

[]

[]

[]

[]

[]

(R/t)

[]

[]

[]

U

[]

U

[]

[]

[]

روش تحقیق

()

[]

[]

[]

C

[]

نیروهای اعمالی

$$P_z = \frac{T_x R_y + T_y R_x}{R_y R_x} \quad ()$$

Y X

R_y R_x

()

m

$$\sigma_x - \sigma_z = m\sigma_f \quad -C \leq Z \leq \frac{t}{2} \quad ()$$

$$\sigma_z - \sigma_x = m\sigma_f \quad \frac{-t}{2} \leq Z \leq -C \quad ()$$

()-() ()

()

$$\sigma_{xi} = -P_z - \sigma_f \left[m + Ln \left[\left(\frac{R_x + z}{R_{xi}} \right)^m \left(\frac{R_y + z}{R_{yi}} \right) \right] \right] \quad ()$$

$$\sigma_{yi} = -P_z - \sigma_f \left[1 + Ln \left[\left(\frac{R_x + z}{R_{xi}} \right)^m \left(\frac{R_y + z}{R_{yi}} \right) \right] \right] \quad ()$$

$$\sigma_{zi} = -P_z - \sigma_f \left[Ln \left[\left(\frac{R_x + z}{R_{xi}} \right)^m \left(\frac{R_y + z}{R_{yi}} \right) \right] \right] \quad ()$$

()

$$\sigma_{xii} = \sigma_f \left[m + Ln \left[\left(\frac{R_x + z}{R_{x0}} \right)^m \left(\frac{R_y + z}{R_{y0}} \right) \right] \right] \quad ()$$

$$\sigma_{yii} = \sigma_f \left[1 + Ln \left[\left(\frac{R_x + z}{R_{x0}} \right)^m \left(\frac{R_y + z}{R_{y0}} \right) \right] \right] \quad ()$$

$$\sigma_{zii} = \sigma_f \left[Ln \left[\left(\frac{R_x + z}{R_{x0}} \right)^m \left(\frac{R_y + z}{R_{y0}} \right) \right] \right] \quad ()$$

R_{y0} R_{x0}

جابجایی محور خنثی

z

$$e^{-\frac{P_z}{\sigma_f}} = \frac{(R_x - C)^{2m} (R_y - C)^2}{R_{xi}^m R_{x0}^m R_{yi} R_{y0}} \quad ()$$

C

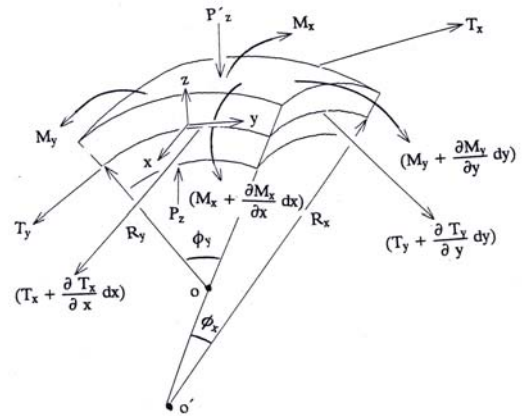

تغییرات ضخامت در حین تغییر شکل

()

$$t = Z_{0.5} + 0.5t_0 \quad ()$$

Z_{0.5}

روابط تعادل

z

$$\frac{d\sigma_z}{dz} = (\sigma_x - \sigma_z)k_x + (\sigma_y - \sigma_z)k_y \quad ()$$

$$k_y = 1/R_y \quad k_x = 1/R_x$$

$$\sigma_y - \sigma_z = \sigma_f \quad -C \leq Z \leq \frac{t}{2} \quad ()$$

$$\sigma_z - \sigma_y = \sigma_f \quad \frac{-t}{2} \leq Z \leq -C \quad ()$$

\sigma_f

$$E = E_0 e^{\left(e \bar{\varepsilon}^{-3} + f \bar{\varepsilon}^{-2} + g \bar{\varepsilon} \right)} \quad ()$$

[]

g f e

$$C = R_Y - \sqrt{R_{Yi} R_{Yo} e^{\frac{-P_z}{\sigma_f}}} \quad ()$$

[]

محاسبه مقدار m

() ()

(F f)

$$f = \frac{3}{2} (S - \alpha) : (S - \alpha) - Y^2 \quad ()$$

$$F = \frac{3}{2} (S - \beta) : (S - \beta) - (B + R)^2 = 0$$

β α Y

R B

$$T_x = \int_{-\frac{t}{2}}^{-C} \sigma_{xl} dz + \int_{-C}^{\frac{t}{2}} \sigma_{xll} dz$$

$$T_y = \int_{-\frac{t}{2}}^{-C} \sigma_{yl} dz + \int_{-C}^{\frac{t}{2}} \sigma_{yll} dz \quad ()$$

T_y T_x

$$T_y - T_x = \int_{-\frac{t}{2}}^{-C} (m-1) \sigma_f dz + \int_{-C}^{\frac{t}{2}} (1-m) \sigma_f dz \quad ()$$

m

محاسبه کرنشها

$\alpha^* = \alpha - \beta$

$$\dot{\alpha}_* = \sqrt{\frac{2}{3}} C a p \left[\mathbf{n}_p - \sqrt{\frac{\alpha_*}{a}} \mathbf{n}_* \right] \quad ()$$

$$\bar{\alpha}_* = \sqrt{\frac{3}{2}} \alpha_* : \alpha_*$$

$$\dot{p} = \sqrt{(2/3) D^p} : D^p \quad a = B + R - Y$$

C'

$$\varepsilon_x = \text{Ln} \left(1 + \frac{z+C}{R_x} \right) + \frac{1}{E} \left(\frac{T_x}{t} - \nu \frac{T_y}{t} \right)$$

$$\varepsilon_y = \text{Ln} \left(1 + \frac{z+C}{R_y} \right) + \frac{1}{E} \left(\frac{T_x}{t} - \nu \frac{T_y}{t} \right) \quad ()$$

$$\varepsilon_z = \text{Ln} \left(\frac{t}{t_0} \right) - \frac{\nu}{E} \frac{T_x + T_y}{t}$$

ε_y ε_x

T_y T_x

$$\frac{R_x O^{(T_x - \nu T_y)} - R_y O^{(T_y - \nu T_x)}}{(R_x - R_y)} = 1 \quad ()$$

$$O = e^{\frac{-1}{E}}$$

ε_z

([])

معادلات برگشت فنری

m

$$\bar{\varepsilon} = \frac{1+r}{\sqrt{1+2r}} \sqrt{\varepsilon_x^2 + \varepsilon_y^2 + \frac{2r}{1+r} \varepsilon_x \varepsilon_y} \quad ()$$

محاسبه تنش سیلان

$$M_x = \int_{-\frac{t}{2}}^{-C} \sigma_{xl} Z dz + \int_{-C}^{\frac{t}{2}} \sigma_{xll} Z dz \quad ()$$

روش آزمایشگاهی

$$M_y = \int_{-\frac{t}{2}}^{-C} \sigma_{yl} Z dz + \int_{-C}^{\frac{t}{2}} \sigma_{yII} Z dz \quad ()$$

()

$$M_x - \Delta M_x = 0 \quad ()$$

$$M_y - \Delta M_y = 0$$

SPCC

$$\Delta M_x = \int_{-\frac{t}{2}}^{\frac{t}{2}} \frac{E}{1-\nu^2} \Delta \epsilon_x Z dz \quad ()$$

$$\Delta M_y = \int_{-\frac{t}{2}}^{\frac{t}{2}} \frac{E}{1-\nu^2} \Delta \epsilon_y Z dz \quad ()$$

CATIA

روش عددی محاسبات

()

نتایج و بحث

()

()

m

m

[]

()

به SPCC

ورقهای فولادی با کیفیت مناسب برای شکلدهی براساس استاندارد JIS G3141 (اطلاق می گردد)

()

(t/2)

(-t/2)

)

(

SPCC

:

E_0 (GPa)	ν	Y (MPa)	c
	l		
B (MPa)	R_{sat} (MPa)	b (MPa)	m

:

(mm)	(Kg)		(mm)		
t	T_y	T_x	R_y	R_x	
l		l			
l		l			
l		l			

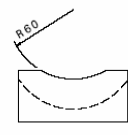

Front view

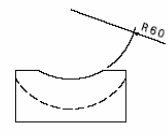

Left view

[-]

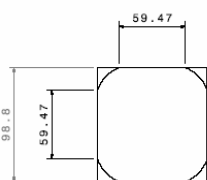

Top view

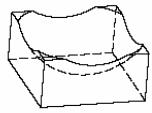

Isometric view

(
y x

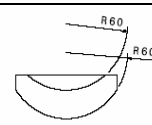

Front view

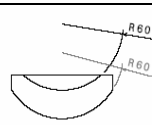

Left view

(

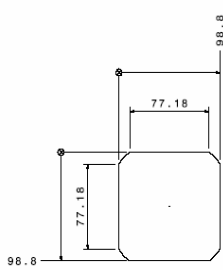

Top view

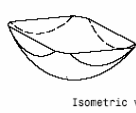

Isometric view

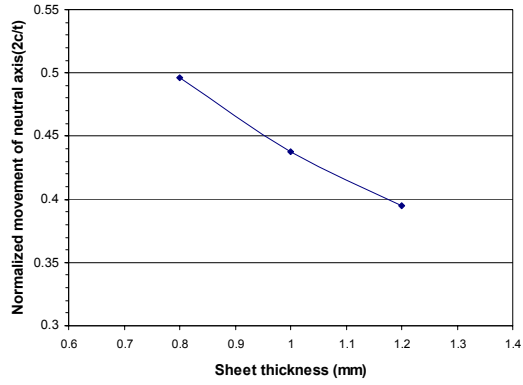

(2C/t)

()

() ()

نتیجه گیری

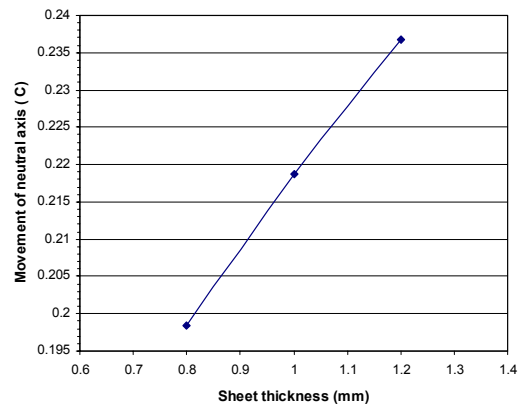
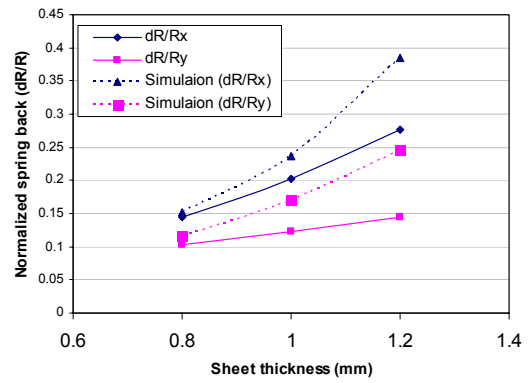

مراجع

- 1- Gangi, M.R, Parsa, M. H. and Mashhadi, M. M. (1998). "Prediction of spring back in anisotropic sheet with two curvature." *The Second Annual Conference of Iranian Metallurgical Society*, Sharif University of Technology, Tehran, Iran, PP.427-436.
- 2 - Gardiner, F. J. (1975). "The springback of metals." *Trans. ASME*, Vol. 79, PP. 1-9.
- 3 - Crandall, S. H. (1957). "Discussion of Gardiner's paper." *Trans. ASME*, Vol. 79, PP. 7-8.
- 4 - Queener, C. A. and DeAngelis, R. J. (1968). "Elastic springback and residual stress in sheet metal formed by bending." *A.S.M. Transactions*, Vol. 61, PP. 757-768.
- 5 - Hill, R. (1951). *The mathematical theory of plasticity*, London, Oxford University Press.
- 6 - Proksa, F. (1959). *Plastische biegen von blechen, der stahlbau*, PP. 29-36.
- 7 - Zhang, Z. T. and Lee, D. (1995). "Devolpement of a new model for plane strain bending and springback analysis." *Journal of materials Engineering Performance*, Vol. 4, No. 3, PP. 291-300.
- 8 - Samuel, M. (2000). "Experimental and numerical prediction of springback and side wall curl in U-bendings of anisotropic sheet metals." *Journal of Materials Processing Technology*, Vol. 105, PP. 382-393.
- 9 - Pourboghrat, F. And Chu, E. (1995). "Prediction of spring-back and side-wall curl in 2-D draw bending." *Journal of Materials Processing Technology*, Vol. 50, PP. 361-374.
- 10 - Jenn-Terng Gau, Gary L. Kinzel, (2001). "A new model for springback prediction in which the Bauschinger effect is considered." *International Journal of Mechanical Sciences*, Vol. 43, PP. 1813-1832.
- 11 - Geng, Lumin and Wagoner, R. H. (2002). "Role of plastic anisotropy and its evolution on springback." *Int. J. Mech. Sci.*, Vol. 44, PP. 123-148.
- 12 - Fusahito Yoshida, Takeshi Uemori, Kenji Fujiwara, (2002). "Elastic-plastic behavior of steel sheets under in-plane cyclic tension-compression at large strain." *International Journal of Plasticity*, Vol. 18, PP. 633-659.
- 13 - Yoshida, F. and Uemori, T. (2002). "A model of large-strain cyclic plasticity describing the Bauschinger effect and workhardening stagnation." *International Journal of Mechanical Sciences*, Vol. 18, PP. 661-686.
- 14 - Yoshida, F. and Uemori, T. (2003). "A model of large-strain cyclic plasticity and its application to springback simulation." *International Journal of Mechanical Sciences*, Vol. 45, PP. 1687-1702.
- 15 - Xue, P., Yu, T. X. and Chu, E. (1999). "Theoretical prediction of the springback of metal sheets after a double-curvature forming operation." *International Journal of Mechanical Sciences*, Vol. 89-90, PP. 65-71.
- 16 - Xue, P., Yu, T. X. and Chu, E. (2001). "An energy approach for predicting springback of metal sheets after double-curvature forming Part I: axisymmetric stamping." *International Journal of Mechanical Sciences*, Vol. 43, PP. 1893-1914.
- 17 - Xue, P., Yu, T. X. and Chu, E. (2001). "An energy approach for predicting springback of metal sheets after double-curvature forming Part II: Unequal double-curvature forming." *International Journal of Mechanical Sciences*, Vol. 43, PP. 1915-1924.
- 18 - Asnafi, N. (2001). "On springback of double-curved autobody panels." *International Journal of Mechanical Sciences*, Vol. 43, PP. 5-37.